

# PAC-42GF

## 4-slot Full-size Compact Chassis



### Features

- ◆ RoHS compliant design
- ◆ 2 x USB ports on front panel
- ◆ 1 x front-accessible 3.5" with 2 x 2.5" HDD or 2 x 3.5" HDD drive capacity
- ◆ Hot-replaceable 8 cm cooling fan

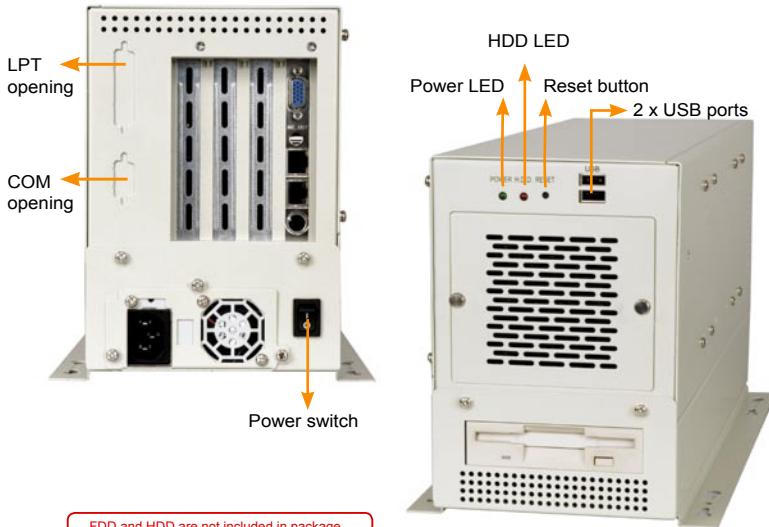

FDD and HDD are not included in package.

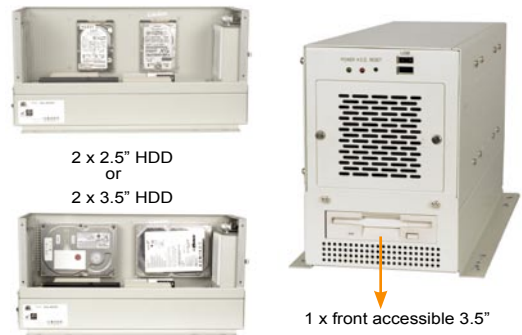

### Dimensions

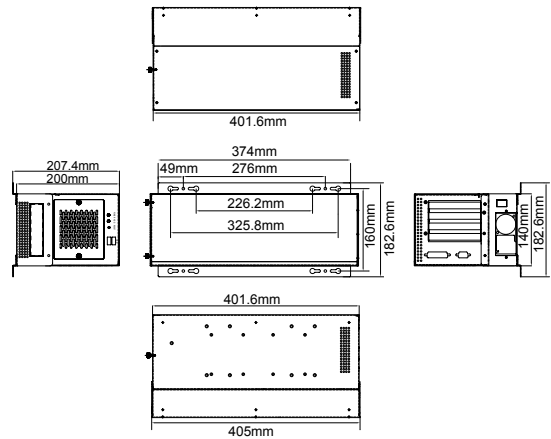

### Specifications

◆ Construction	Heavy duty metal
◆ SBC Form Factor	Full-size, slot CPU cards
◆ Drive Bays	1 x front-accessible 3.5" with 2 x 3.5" HDD or 1 x front-accessible 3.5" with 2 x 2.5" HDD
◆ Cooling Fans	1 x 8 cm
◆ I/O ports	2 x USB
◆ I/O openings	1 x LPT , 1 x COM
◆ Expansion Slots	4 slots
◆ Indicators	Power, HDD
◆ Buttons	Power switch, reset
◆ Operating Temperature	0~50°C
◆ Operation Humidity	10% ~ 90%
◆ Color	W: White
◆ Weight (Net/Gross)	4.6kg / 6.8kg
◆ Dimensions (DxWxH)	405mm x 140mm x 200mm

### Backplane Options

Model No.	SBC Type	PCI	ISA	PCIe			PSU Connector
				x1	x4	x16	
PCI-4S-RS-R30	PICMG 1.0	3	1	0	0	0	AT/ATX
PE-4S	PCIMG 1.3	1	0	1	1	1	ATX
PE-4S2	PCIMG 1.3	2	0	0	0	1	ATX
PE-4S3	PCIMG 1.3	0	0	2	0	1	ATX
HPE-4S1	PCI/PICoE	3	0	0	0	0	ATX
HPE-4S2	PCI/PICoE	2	0	0	1	0	ATX

### Power Supply Options

Type	Model No.	Watt
AT	ACE-916AP-RS	150W
	ACE-816AP-RS	150W
ATX	ACE-4518AP-RS	180W

PAC-42GF can support single 1U height PSU. For more models of IEI PSU, please visit www.ieiworld.com.

### Ordering Information

Part No.	Description
PAC-42GFW/ACE-4518AP/PCI-4S	4-slot full-size chassis, white, with ACE-4518AP-RS and PCI-4S-RS-R30, RoHS